

6"

SUPER DOMINATOR 600

One piece top-adaptor reduces internal parts. No make up required. External N.R.V. for easy maintenance.

Revised chamber volumes and cycle timing to optimize performance.

Simplified piston geometry for improved balance and location within the cylinder.

DHD 360 and Cop 64 shank reduces contact stresses and wear rates.



The Super Dominator 600 is one of the fastest 6" hammers specifically designed for high production drilling in blast-hole applications. The Super Dominator 600 is a reduced weight hammer with waterwell drilling capabilities. The unique one piece top-adaptor with N.R.V. (Non-Return-Valve) makes it easy to maintain and service the hammer.

Super Dominator 600 requires only few tools to service and maintain the hammer.

Suitable for operation at air pressures of 100 - 435 psi (7 - 30 bar).

Drilling diameters of 135mm - 165mm (6 1/8 - 9 1/2").

Air Consumption

Super Dominator 600 Air Consumption

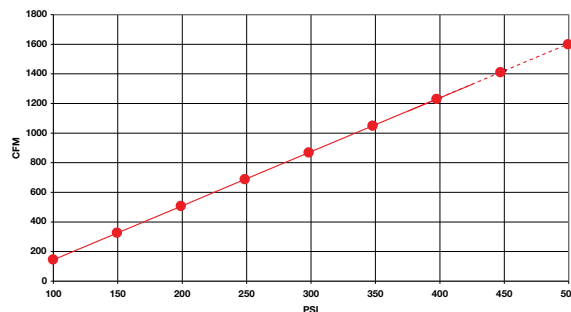

Available Shanks

IR DHD 360

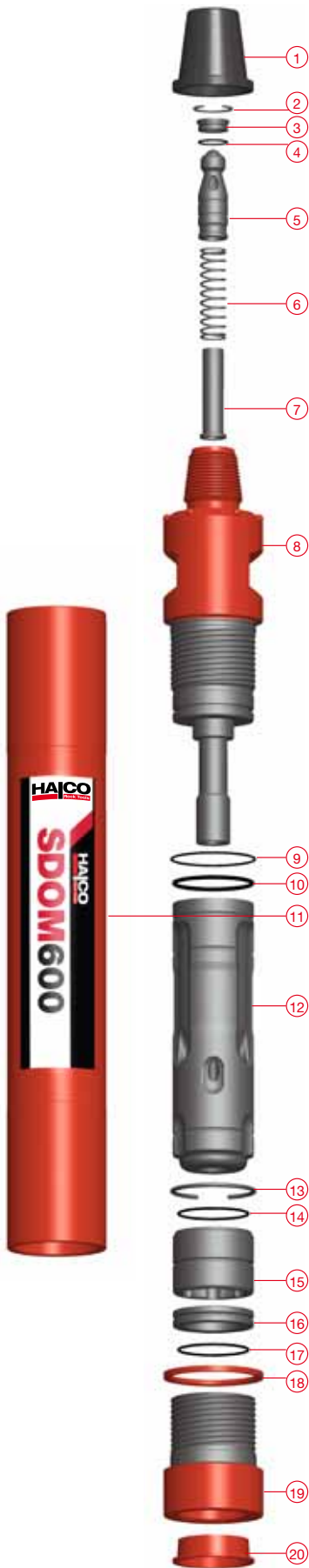

Hammer Overview

Hammer Type	Super Dominator 600
Part Number	600272
Shank	Ingersoll Rand
	DHD 360
Top Thread	3 .1/2" Api Reg Pin
Flat Hammer Size	101mm (3.977")
Weight	100 Kg
Outside Diameter	140mm (5.511")
Make Up Length	1139mm (44.842")
Recommended Minimum Thrust	500 Kg (1100 Lbs)
Recommended Maximum Thrust	1500 Kg (3300 Lbs)

Parts List

Hammer Type		Super Dominator 600		
Shank		IR DHD 360	SK37	RK65
Model Number		600272	Contents	
Item	Description	Part Number	Quantities	
1	Thread Protector	201701	-	-
2	Snap Ring	783050	2	2
3	N.R.V. Seat	603872	-	1
4	O'Ring	768112	2	2
5	Non Return Valve	603554	-	1
6	N.R.V. Spring	760135	2	2
7	N.R.V. Spring Shield	603652	-	1
8	Top-Adaptor	603506	-	-
9	O'Ring	768140	2	2
10	O'Ring	768055	2	2
11	Cylinder	603584	-	-
12	Piston	602891	-	-
13	Snap Ring	783017	2	2
14	O'Ring	747105	2	2
15	Bit Guide Bush	602239	-	1
16	Bit Retaining Ring	603749	-	1
17	O'Ring	747105	2	2
18	Chuck Spacer	601942	-	1
19	Chuck	602495	-	1
20	End Cap	741009	-	-
SK	Service Kit	SK37		
RK	Repair Kit	RK65		
	Foot Valve	601595		
	F/V Tool - Body	601878		
	F/V Tool - Pusher	601569		

Drill Bits

Part Number	Diameter		Face Design	Type	Button Qty	Over Size	Weight (Kg)
	mm	Inch					
Ingersoll Rand (DHD360) / Atlas Copco Cop64							
650783	152	6	Convex	Domed	20 x 16mm		25
650789	165	6.1/2	Concave	Domed	18 x 16mm		25.5
650795	165	6.1/2	Convex	Domed	20 x 16mm		26
653134	165	6.1/2	Convex	Domed	16 x 16mm / 12 x 16mm Long		25
653038	170	6.3/4	Concave	Domed	18 x 16mm		26.5
653097	180	7	Concave	Domed	18 x 16mm	Y	27.3
653098	190	7.1/2	Concave	Domed	24 x 16mm	Y	30
653023	200	7.7/8	Convex	Domed	21 x 16mm	Y	34.5
650673	203	8	Concave	Domed	31 x 16mm	Y	35.2
650335	203	8	Convex	Domed	21 x 16mm	Y	35
650684	220	8.5/8	Concave	Domed	22 x 20mm	Y	40
650696	241	9.1/2	Flat	Domed	18 x 16mm / 10 x 20mm	Y	50

Halco Rock Tools
Quality Management System
is Certified to ISO9001: 2008
Certificate No: LRQ 0850659



West lane, Southowram, Halifax, HX3 9TW

Tel: + 44 (0) 1422 399900, Fax: + 44 (0) 1422 330186

Email: salesuk@halcorocktools.com • salesusa@halcorocktools.com • salesaus@halcorocktools.com

halcorocktools.com