

# 4"

## GW 400

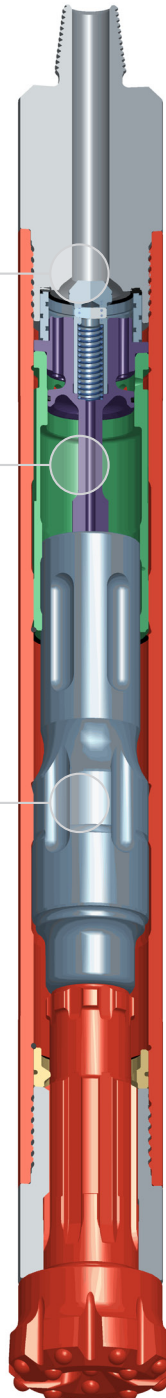

Choke system to allow adjustment of air flow to improve flushing

Optimised drive chamber capacities to maximise hammer performance

Robust simple piston design for optimum strength and performance

The New GW400 High Performance hammer drills under a head of water typically suited to Waterwell and Geothermal applications.

It's robust non-ported piston design improves the hammer strength and increases air flow efficiency. A choke facility helps to adjust air flow through the hammer.

Suitable for operation at air pressures up to 30 bar.

### Air Consumption

GW 400 Air Consumption

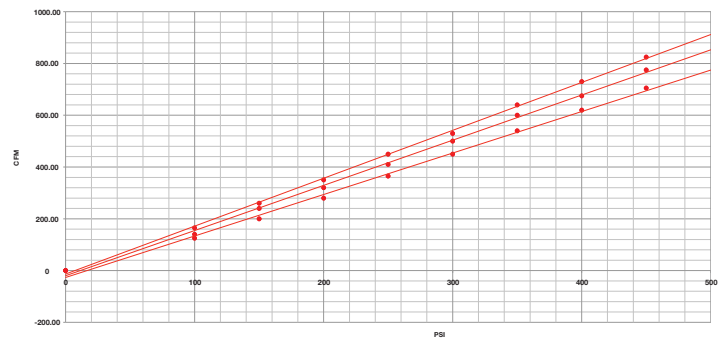

Figures are based on theoretical data

### Available Shanks

DHD 340A

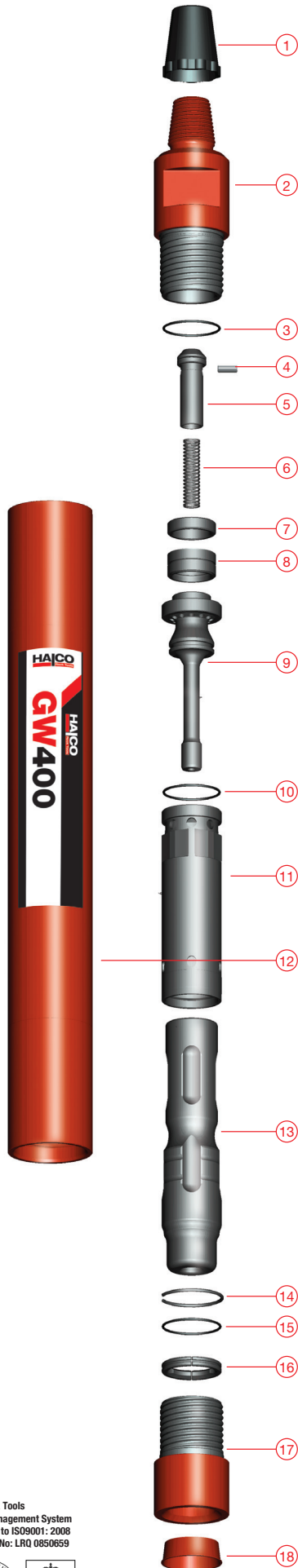

## Hammer Overview

<b>Hammer Type</b>	<b>GW400</b>
<b>Part Number</b>	<b>600402</b>
Shank	DHD340
Top Thread	2 3/8 API REG PIN
Weight	40 kg
Outside Diameter	98 mm (3858")
Make Up Length	954 mm (37.559")
Recommended Minimum Thrust	250 kg (550 lbs)
Recommended Maximum Thrust	500 kg (1100 lbs)

## Parts List

Hammer Type	GW400	SK72	RK123
Model Number	DHD340 A	Contents	
Item	Description	600402	Quantities
1	Thread Protector	200111	- -
2	Top Adaptor	604568	- -
3	O Ring	768190	2 2
4	NRV Plug - Blank	604480	2 2
	NRV Plug - 1/8"	604481	2 2
	NRV Plug - 3/16"	604382	2 2
5	NRV	604444	- 1
6	NRV Spring	760079	2 2
7	4.9 mm Shim	602634	- 1
	5.3 mm Shim	602635	- 1
	5.7 mm Shim	602636	- 1
8	Nested Wave Spring	760160	- 1
9	Air Distributor	604571	- -
10	O Ring	768204	2 2
11	Liner	604570	- -
12	Cylinder	604569	- -
13	Piston	604572	- -
14	Snap Ring	783029	1 1
15	O Ring	768204	2 2
16	Bit Retaining Rings	604573	- 1
17	Chuck	604574	- 1
18	End Cap	741046	- -
	Service Kit	SK72	
	Repair Kit	RK123	
	Foot Valve	601773	
	F/V tool - Body	601643	
	F/V tool - Pusher	601644	

## Drill Bits

Part Number	Diameter mm	Inch	Face Design	Type	Button Qty / Dia	Over Size	Weight (kg)
<b>IR DHD 340A Shank/ Atlas Copco Cop 44</b>							
650950	108	4 1/4	Convex	Domed	15 x 13 mm		8
650968	108	4 1/4	Convex	Semi-Ballistic	15 x 13 mm		10
650949	110	4 5/16	Convex	Domed	15 x 13 mm		8.1
650961	110	4 5/16	Convex	Semi-Ballistic	15 x 13 mm		8.1
653091	110	4 5/16	Convex	Parabolic	14 x 14 mm		8.5
650526	115	4 1/2	Convex	Domed	16 x 13 mm		8.2
650625	115	4 1/2	Concave	Domed / Semi-Ballistic	8 x 14 mm D / 6 x 13 mm S / B		8.2
650955	115	4 1/2	Flat	Domed	8 x 14 mm / 10 x 13 mm		8.3
650967	115	4 1/2	Convex	Semi-Ballistic	16 x 13 mm		8.5
650680	120	4 3/4	Concave	Domed / Semi-Ballistic	8 x 13 mm/8 x 13mm		10
650612	121	4 3/4	Convex	Semi-Ballistic	14 x 13 mm		9.5
650611	127	5	Concave	Domed	16 x 13 mm	Y	9.5
650966	127	5	Concave	Semi-Ballistic	16 x 13 mm	Y	9.6
650013	127	5	Convex	Domed	16 x 13 mm	Y	10.6
650614	130	5 1/8	Concave	Domed / Semi-Ballistic	8 x 14 mm D / 8 x 13 mm S / B	Y	10.1
650675	130	5 1/8	Convex	Semi-Ballistic	16 x 13 mm	Y	9.2
653094	140	5 1/2	Concave	Domed	9 x 16 mm/9 x 14 mm	Y	11.8

Halco Rock Tools  
Quality Management System  
is Certified to ISO9001: 2008  
Certificate No: LRQ 0850659



West lane, Southowram, Halifax, HX3 9TW

Tel: + 44 (0) 1422 399900, Fax: + 44 (0) 1422 330186

Email: salesuk@halcorocktools.com • salesusa@halcorocktools.com • salesaus@halcorocktools.com

halcorocktools.com