

8"

DOMINATOR 880

One piece top-adaptor reduces internal parts. No make up required. External N.R.V. for easy maintenance.

Reversible cylinder.

Simplified piston geometry for improved balance and location within the cylinder.

Revised chamber volumes and cycle timing to optimize performance.

IR QL80 shank reduces contact stresses and wear rates.

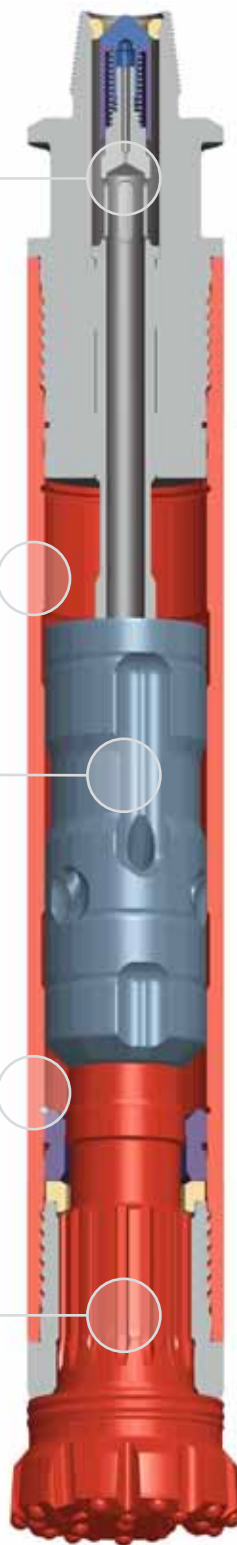

The Dominator 880 is a general purpose hammer suitable for a wide range of air pressures.

The Dominator 880 is a well drilling hammer with a mid to high range air volume. The one piece top-adaptor with N.R.V. (Non-Return-Valve) makes it easy to maintain and service the hammer. A choice of blank, 4mm, 6mm or 8mm chokes can be fitted to provide varied air flow making the Dominator 880 a versatile hammer. The wide body diameter of the Dominator 880 allows for an increased piston weight and therefore an improved performance. The unique air distributor integral with top-adaptor reduces requirements for shimming.

Suitable for operation at air pressures of 100 - 435 psi (7 - 30 bar).

Drilling diameters of 200 - 311 mm (7 7/8 - 12 1/4").

Air Consumption

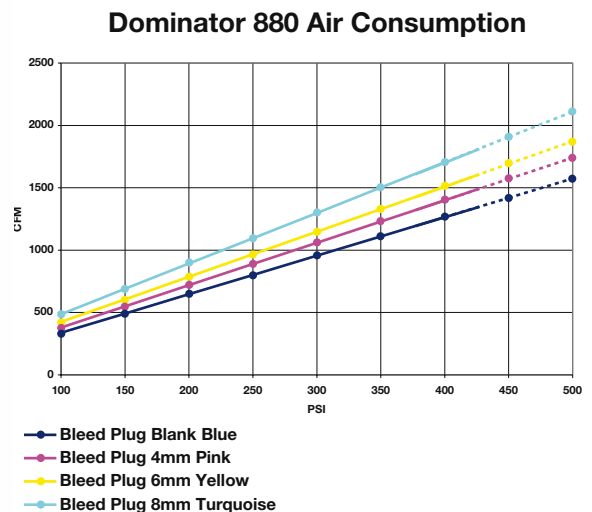

Available Shanks

IR QL 80

IR DHD 380

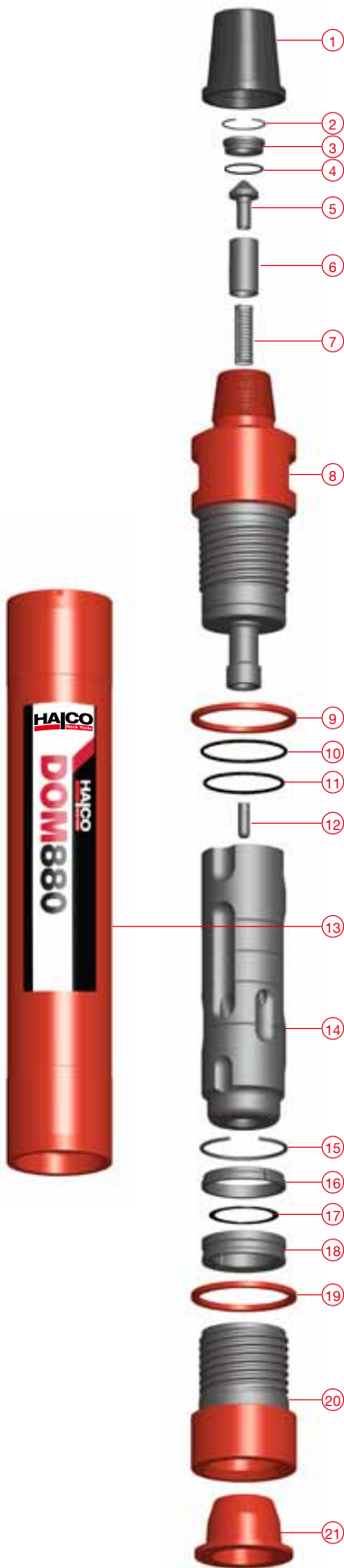

Hammer Overview

Hammer Type	Dominator 880	
Part Number	600311	600312
Shank	Sandvik Mission A63-15/SD8	Ingersoll Rand DHD 380
Top Thread	4. 1/2" Api Reg Pin	4. 1/2" Api Reg Pin
Flat Hammer Size	156mm (6.142")	156mm (6.142")
Weight	177 Kg	177 Kg
Outside Diameter	182mm (7.165")	182mm (7.165")
Make Up Length	1263mm (49.724")	1263mm (49.724")
Recommended Minimum Thrust	800kg (1760 Lbs)	800kg (1760 Lbs)
Recommended Maximum Thrust	2000kg (4400 Lbs)	2000kg (4400 Lbs)

Parts List

Hammer Type	Dominator 880			
Shank	A63-15 / SD8	DHD 380	SK51	RK79
Model Number	600311	600312		
Item	Description	Part Number	Contents Quantities	
1	Thread Protector	207295	207295	- -
2	Snap Ring	783034	783034	2 2
3	N.R.V. Seat	602887	602887	- 1
4	O'Ring	768150	768150	2 2
5	Non Return Valve	602285	602285	- 1
6	N.R.V. Cover	603696	603696	- 1
7	N.R.V. Spring	760108	760108	2 2
8	Top-Adaptor	603607	603607	- -
9	Spacer	603576	603576	1 1
10	O'Ring	768103	768103	2 2
11	O'Ring	768145	761845	2 2
12*	Blank Plug (Blank)	602450	602450	- -
	Blank Plug (4mm)	602451	602451	- -
	Blank Plug (6mm)	602452	602452	- -
	Blank Plug (8mm)	602453	602453	- -
13	Cylinder	603691	603691	- -
14	Piston	603614	602654	- -
15	Snap Ring	783015	783015	2 2
16	Spacer	-	602840	- 1
17	Containment Band	768102	603549	- -
18	Bit Ring	601839	603043	- 1
19	Chuck Spacer	603576	603576	1 1
20	Chuck	603686	603495	- 1
21	End Cap	741027	741027	- -
SK	Service Kit	SK51	SK25	
RK	Repair Kit	RK79	RK64	
	Foot Valve	601828	601819	
	F/V Tool - Body	601829	601820	
	F/V Tool - Pusher	601569	601569	

Drill Bits

Part Number	Diameter mm	Inch	Face Design	Type	Buttons Qty	Over Size	Weight (Kg)
Sandvik Mission A63-15/SD8 Shank							
650959	200	7.7/8	Concave	Domed	12x16mm/9x20mm/6x13mm		43.0
650375	203	8	Concave	Domed	10x20mm / 14x16mm		43.5
650922	203	8	Concave	Domed/S-Ballistic	10x20mmd/14x16mmsb		43.0
650837	219	8.5/8	Concave	Domed	18 x 20mm		46.0
650705	222	8.3/4	Concave	Domed	24 x 20mm		46.5
650357	241	9.1/2	Concave	Domed	18 x 20mm		52.5
650606	254	10	Concave	Domed	11x16mm / 18 x 20mm		56.5
650037	254	10	Flat	Domed	28 x 20mm		58.3
653105	270	10.5/8	Concave	Domed	34 x 18mm		57.0
650039	300	11.7/8	Flat	Domed	29 x 20mm	Y	84.5
Ingersoll Rand Shank - DHD 380							
650977	200	7.7/8	Concave	Domed	31 x 16mm		52.0
650373	203	8	Concave	Domed	10 x 20mm / 14 x 16mm		51.5
650022	241	9.1/2	Concave	Domed	10 x 16 / 18 x 20mm		56.9
650389	254	10	Concave	Domed	18 x 20mm / 10x16mm		64.5
650898	300	11.7/8	Convex	Domed	34 x 20mm	Y	84.5
653041	311	12.1/4	Concave	Domed	42 x 20mm	Y	84.1

Halco Rock Tools
Quality Management System
is Certified to ISO9001: 2008
Certificate No: LRQ 0850659



West lane, Southowram, Halifax, HX3 9TW

Tel: + 44 (0) 1422 399900, Fax: + 44 (0) 1422 330186

Email: salesuk@halcorocktools.com • salesusa@halcorocktools.com • salesaus@halcorocktools.com

halcorocktools.com