

# 12"

## SUPER DOMINATOR 1200

Heavy duty top-adaptor with box connection reduces internal parts. No make up required. External N.R.V. for easy maintenance.

Simplified piston geometry for improved balance and location within the cylinder.

Revised chamber volumes and cycle timing to optimize performance.

Replaceable bit bearings.

QL120 shank reduces contact stresses and wear rates.

Replaceable bit bearings.

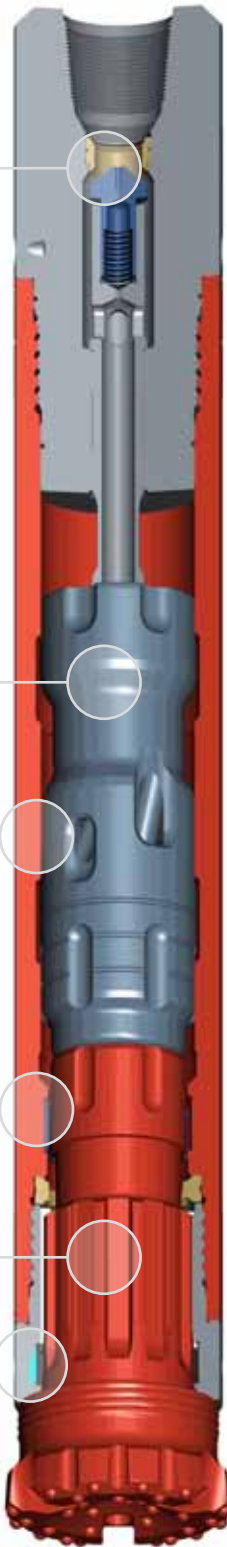

The Super Dominator 1200 accepts QL120 shank bits and drills most efficiently at air pressures between 100 psi (7 bar) and 435 psi (30 bar). Due to its higher air consumption, it provides increased uphole velocity, particularly when using oversized diameter drill bits.

The Super Dominator 1200 has a one piece top-adaptor with N.R.V. (Non-Return-Valve) fitted for easy inspection and service, with integral finger to reduce maintenance and eliminate shimming which increases service intervals. The Super Dominator 1200 has a robust top-adaptor for extra strength.

Suitable for operation at air pressures of 100 - 435 psi (7 - 30 bar).

Drilling diameters of 311 - 445mm (12 - 17 1/2").

### Air Consumption

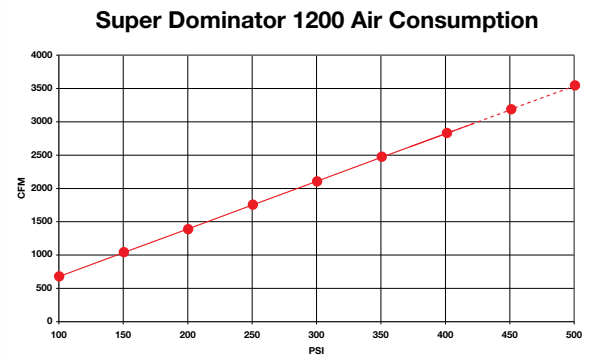

Figures are based on theoretical data

### Available Shanks

IR QL 120

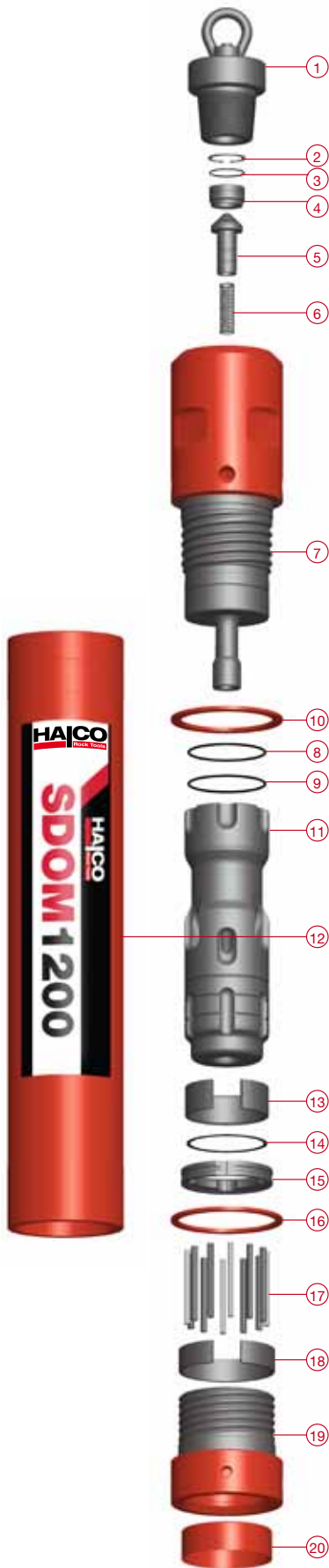

## Hammer Overview

Hammer Type	Super Dominator 1200
Part Number	600373
Shank	Ingersoll Rand QL 120
Top Thread	6 .5/8" Api Reg Box
Flat Hammer Size	260mm (10.236")
Weight	807 Kg
Outside Diameter	284mm (11.181")
Make Up Length	1978mm (77.874")
Recommended Minimum Thrust	1600 Kg (3520 Lbs)
Recommended Maximum Thrust	3500 Kg (7700 Lbs)

## Parts List

Hammer Type	Super Dominator 1200
-------------	----------------------

Shank	Q1120
-------	-------

Model Number	600373
--------------	--------

Item	Description	Part Number
------	-------------	-------------

1	Lifting Cap	604284
---	-------------	--------

2	Circlip	777001
---	---------	--------

3	O'Ring	768133
---	--------	--------

4	N.R.V. Seat	602286
---	-------------	--------

5	Non Return Valve	602288
---	------------------	--------

6	N.R.V. Spring	760055
---	---------------	--------

7	Top-Adaptor	604282
---	-------------	--------

8	Top-Adaptor Spacer	603575
---	--------------------	--------

8	O'Ring	768137
---	--------	--------

10	O'Ring	768137
----	--------	--------

11	Piston	603572
----	--------	--------

12	Cylinder	603565
----	----------	--------

13	Inner Bearing Ring	603566
----	--------------------	--------

14	Containment Band	603581
----	------------------	--------

15	Bit Retaining Ring	603567
----	--------------------	--------

16	Chuck Spacer	603568
----	--------------	--------

17	Drive Pins	600595
----	------------	--------

18	Chuck Bearing	603563
----	---------------	--------

19	Chuck	603562
----	-------	--------

20	End Cap	741050
----	---------	--------

SK	Service Kit	SK47
----	-------------	------

RK	Repair Kit	RK76
----	------------	------

	Foot Valve	603561
--	------------	--------

	F/V - Body	603582
--	------------	--------

	F/V - Pusher	603583
--	--------------	--------

## Drill Bits

Part Number	Diameter		Face Design	Type	Buttons Qty	Weight (Kg)
	mm	Inch				
<b>QL 120 Shank</b>						
653034	311	12.1/4	Concave	Domed	31 x 20mm	168
653089	314	12.3/8	Concave	Domed	32 x 20mm	168
653035	445	17.1/2	Concave	Domed	82x20mm / 30x16mm Wear	271