



HYPER 181 QL200S DTH HAMMER

Technical Brochure



Hyper 181/QL 200 S Valveless Hammer 724mm (28.5") - 864mm (34") dia. Holes

The Bulroc Hyper 181 hammer is a valveless DTH hammer designed to operate efficiently at pressures ranging from 7 to 15.5 bar (100 - 225 psi). The Hyper 181 is supplied with a 8⁵/₈" API regular pin backhead as standard but a 8⁵/₈" API regular box backhead can be supplied.

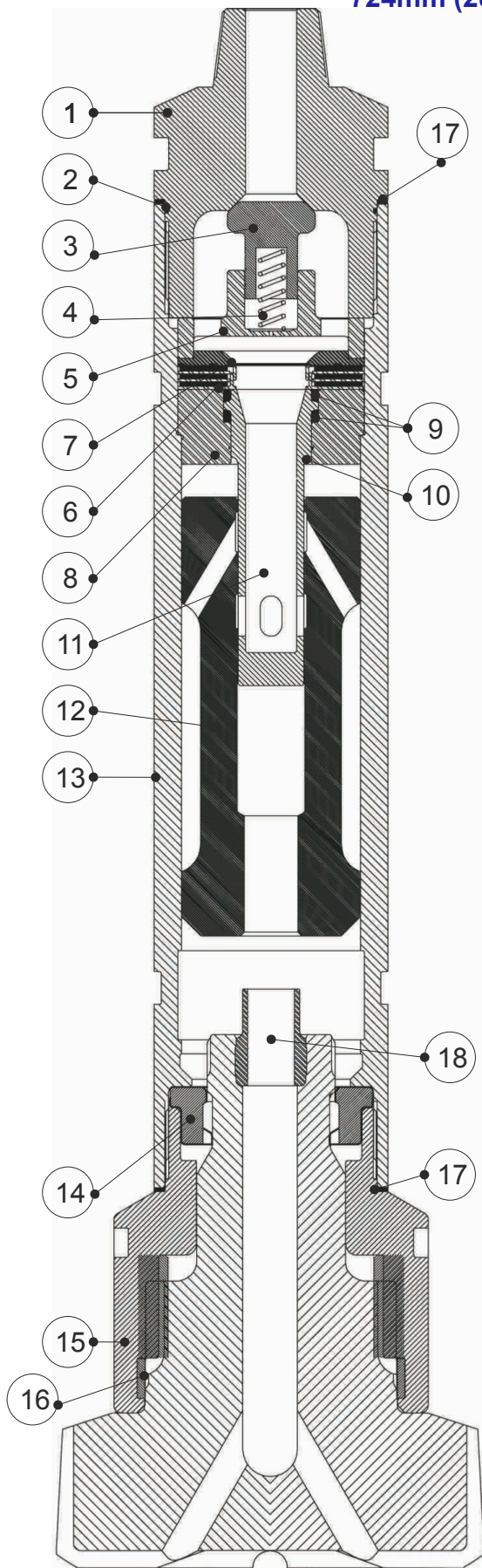

COMPONENT PARTS

Ref	Description	Part Number
1	Backhead 8 ⁵ / ₈ " Reg. Pin	HSH1813882M
2	Backhead 'O' Ring	HSH18114
3	Check Valve	HSH18108
4	Check Valve Spring	HSH18110
5	Valve Chest	HSH18107
6	Compression Buffer	HSH18128
7	Buffer Cover	HSH18173
8	Tube Holder	HSH18131
9	Tube Buffers (2)	HSH18129
10	Tube 'O' Ring	HSH18130A
11	Control Tube	HSH18130
12	Piston	HSH18103180
13	Wearsleeve	HSH18100
14	Bit Retaining Ring	HSH18137101
15	Chuck	HSH18135101
16	Chuck Bearing	HSH18135101BE
17	Breakout Washers (2)	HSH18126
18	Foot valve	BBF 101
Complete Hammer		BR181H04

HAMMER SPECIFICATIONS

	English	Metric
Weight (less bit)	3846 lbs	1748 kg
Length (less bit)	90.66"	2303mm
Outside dia.	16"	406mm
Bore dia.	12.25"	311mm
Piston weight	730 lbs	330 kg
Stroke	5.75"	146mm

AIR CONSUMPTION

PSI	BAR	C.F.M.	Cu. Mtr / min
100	6.9	1097	31.1
150	10.3	2016	57.1
175	12.0	2541	71.9
200	13.8	3105	87.9
225	15.5	3705	104.9

IMPORTANT INFORMATION

When fitting the drive pins inside the chuck slots, it is recommended to put grease on the reverse side of each pin to help secure in position when placing the chuck over the bit. Note the lead chamfer on the pin should, when in position, always face towards the chuck end.



Manufacturers of Rock Drilling Equipment

Turnoaks Business Park, Burley Close, Chesterfield, Derbyshire S40 2UB

Tel: +44(0) 1246 544700 Fax: +44(0) 1246 544701

e-mail: info@bulroc.com website: www.bulroc.com

BRH181QL200S 25/02/13