

Cement Basket

Industrial Rubber Cementing Baskets are constructed of flexible spring steel ribs and reinforced rubber overlapping liners. Cementing Baskets may be run on casing, tubing or liners, and are designed to seal off zones below the basket from contamination by cement slurry. The cementing basket can be slipped on over the run-in string, and its position is determined either by couplings at the ends of the joint or by Casing Stop Collars.

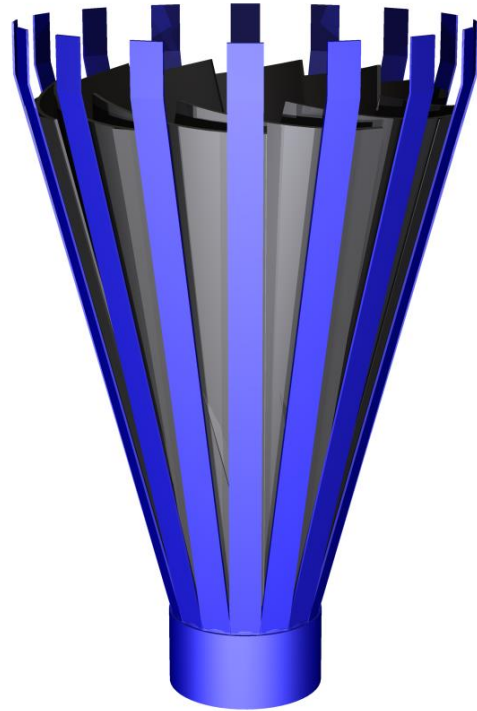

Basket Size	Part Number	Casing Hole Diameter (in.)		Total Weight Capacity (lbs.)	
		Min.	Max.	Min. Hole	Max. Hole
2 3/8"	260-0023	3.625	10.000	5875	963
2 7/8"	260-0027	4.125	10.000	5875	1031
3 1/2"	260-0034	4.750	10.000	5875	1130
4 1/2"	260-0044	5.750	12.000	7750	1292
5 1/2"	260-0054	6.750	14.000	9125	1342
6 5/8"	260-0065	7.875	17.000	10125	1220
7 "	260-0070	8.250	16.000	11375	1580
8 5/8"	260-0085	10.500	18.000	8250	1491
9 5/8"	260-0095	11.500	20.000	10333	1867
10 3/4"	260-0106	12.500	21.000	12143	2073
11 3/4"	260-0116	13.250	22.000	15625	2287
13 3/8"	260-0133	15.500	23.000	12353	2727
16"	260-0160	17.500	26.000	21354	3203
18 5/8"	260-0185	20.000	29.000	28409	3765
20"	260-0200	22.000	30.000	20625	4125
22"	260-0220	24.500	32.000	17875	4469
24"	260-0240	26.500	34.000	19250	4813